

Place and Access

from/to KYOTO STATION

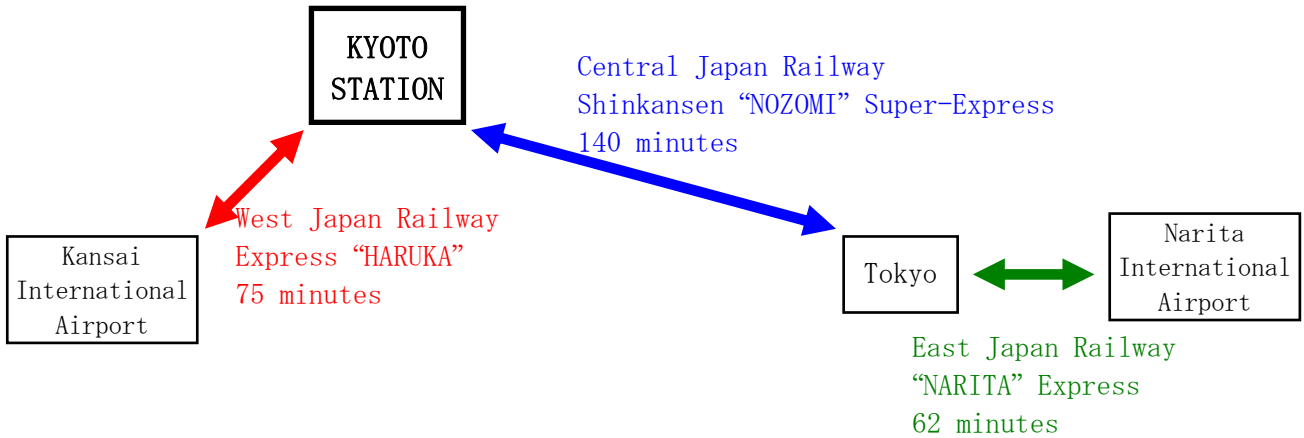

West Japan Railway Express "HARUKA"

Kansai International Airport station (to Kyoto or via Kyoto to Maibara)

Weekday	Saturday, Sunday and Holyday
6:34	6:42
7:27 7:55	7:42
8:46	8:06 8:44
** :16 ** :46 (** = 9 till 20)	** :16 ** :46 (** = 9 till 20)
21:31	21:31
22:16	22:16

Kyoto station (to Kansai International Airport)

everyday
5:46
6:22 6:46
7:16 7:50
8:16 8:50
9:13 9:45
** :15 ** :45 (** = 10 till 19)
20:15

MIELPARQUE-KYOTO, Kyoto Station and Hotels

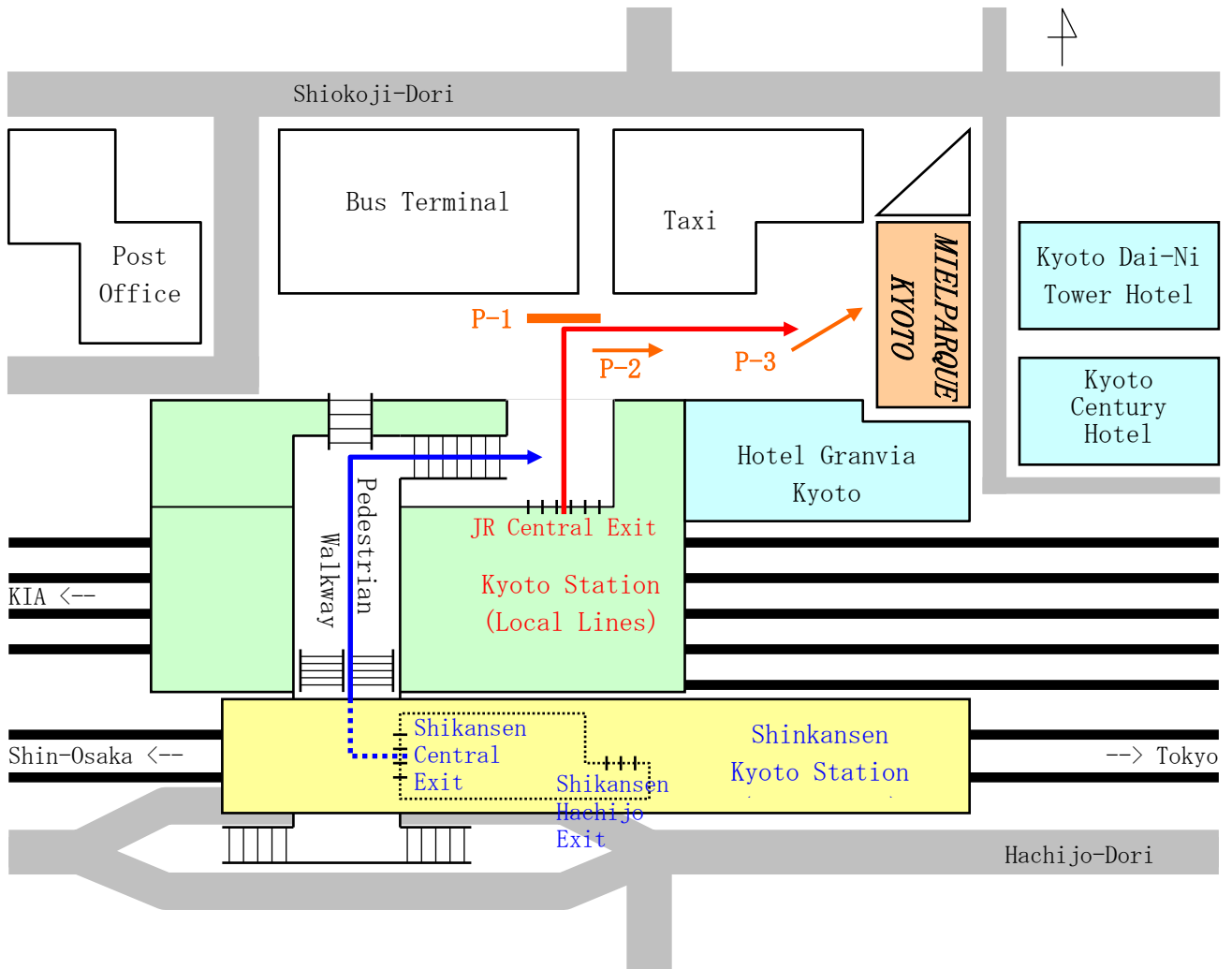

JR : Japan Railway
KIA : Kansai International Airport

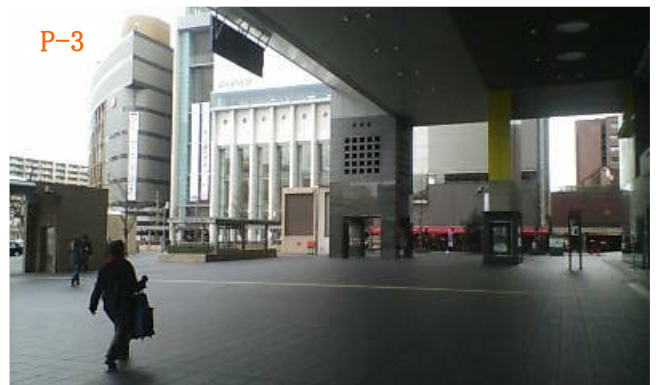

Mielparque-Kyoto

Entrance and Ground Floor

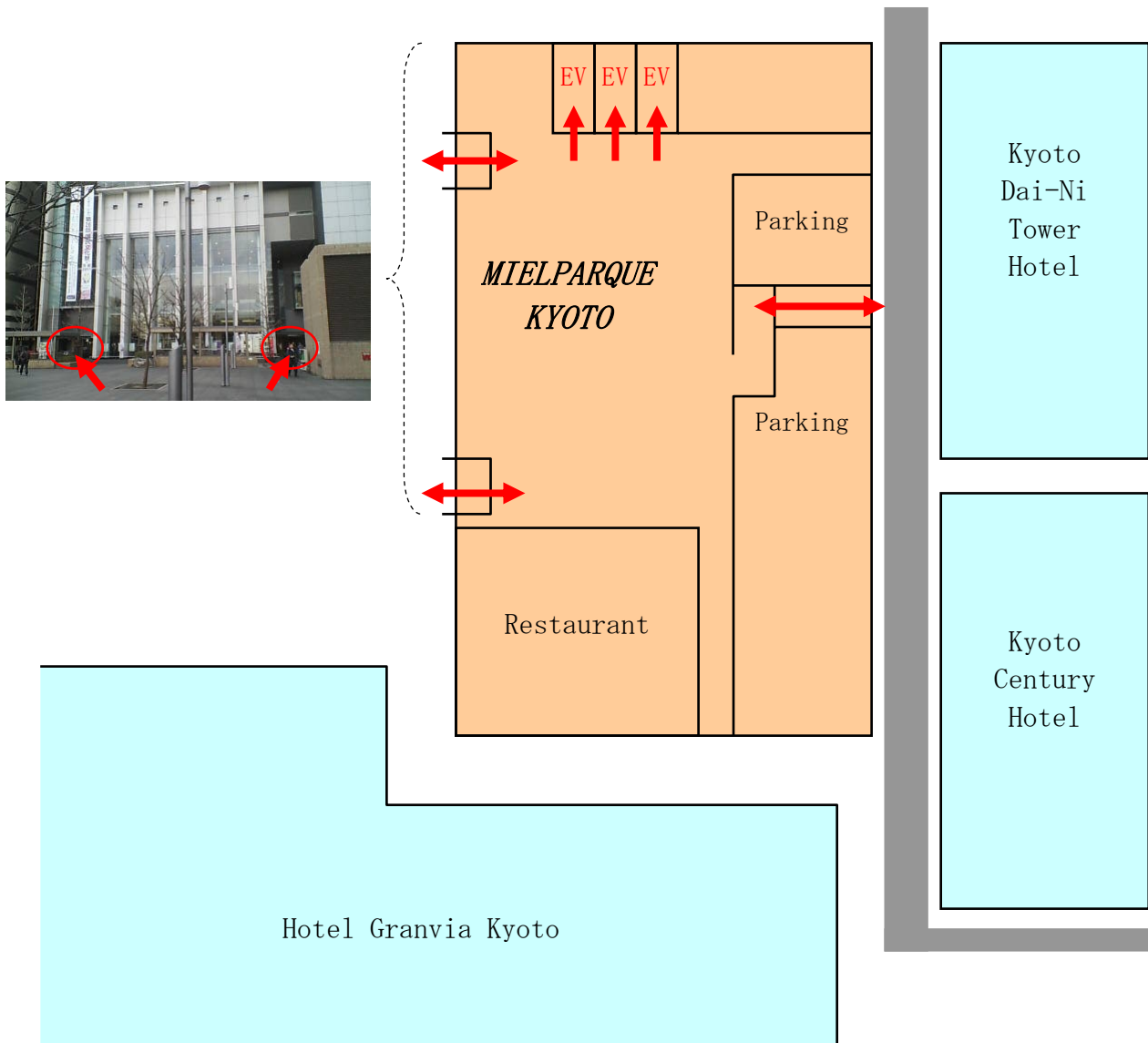

6F

(Day-1 and Day-2) Entry Desk and all Sessions

(Day-1) Lunch

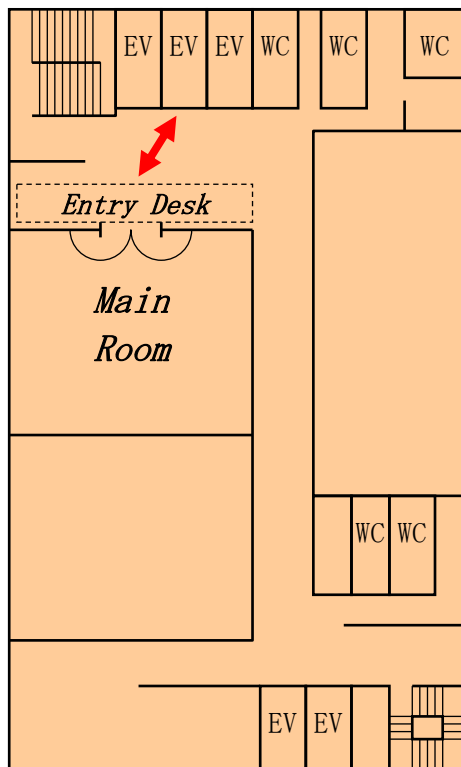

8F

(Day-1) Banquet and Committee meeting

(Day-2) Lunch

